

8.1 Overview

The Sierra Vista Specific Plan includes utility infrastructure required to serve the Plan Area. Each component of the utility infrastructure system is designed to accommodate build out of the SVSP area. Phasing of infrastructure improvements and funding obligations are detailed in the Specific Plan development agreements. Table 8-1 summarizes the utility providers to the SVSP.

Table 8-1: SVSP Utility Providers

Utility	Provider
Potable Water	City of Roseville
Wastewater	City of Roseville
Recycled Water	City of Roseville
Drainage and Flood Control	City of Roseville
Electric Service	City of Roseville
Natural Gas	Pacific Gas and Electric
Communications	AT&T SureWest Comcast Wave Broadband
Solid Waste Disposal	City of Roseville

Utility infrastructure will be constructed, dedicated, and easements will be provided consistent with this Specific Plan, the project development agreements, and other applicable standards and requirements of the City of Roseville.

8.2 Potable Water

The City of Roseville will provide potable water service (supply, treatment, and conveyance) to the SVSP. Water will be delivered to the Plan Area via the City's backbone system at several planned connection points along Baseline Road, Fiddymment Road, Westbrook Boulevard, and Pleasant Grove Boulevard.

A. Water Supply and Demand

The water demand for the Sierra Vista Specific Plan is approximately 5,437 acre feet per year (AFY). This demand will be satisfied with a combination of both potable and non-potable (recycled) water sources. The recycled water component will be utilized for irrigation purposes as outlined in Section 8.3, Recycled Water, below. The City has identified a water supply strategy to reliably supply water to the SVSP. The City's existing water supply is sufficient to serve the project. To supplement water supply during "dry" years when the City's contracted surface water may be reduced, the SVSP includes provisions for three onsite groundwater wells. Each well will be capable of providing up to 2.6 million gallons per day (mgd) of water each.

B. Water Conservation Measures

The SVSP includes significant water savings measures with the goal of reducing the project's overall water demands for both potable and/or recycled water to the best extent feasible and practicable. The following water conservation measures will be implemented in the SVSP in an effort to reach the City's water conservation goals:

- ❑ **Turf Reductions in Residential Areas** – This involves limiting the amount of turf in the front yards of residential properties and using a higher percentage of low-water use plant species in lieu of turf. Typically, about 70% of a total residential front yard is assumed to consist of landscaping, with the balance consisting of driveways, planter, or walkways. For the SVSP, limitations will be placed on the landscaped portion of each front yard, allowing up to 42% of the total area to be turf, with the remaining landscaped area comprised of low water use plant species that use between 65-75% less water than an average lawn.
- ❑ **Turf Reductions in Parks, Paseos, and Landscape Corridors** – This involves limiting the use of turf on non-residential parcels within the SVSP, with a focus on water efficiencies at parks, paseos, and landscape corridors. For these areas, landscape design will reduce the area of turf and increase the area of low-water-use plant species, as compared to the design of these features in

other specific plan areas. To achieve the desired water conservation, the following criteria will be implemented:

- **Parks** – It is assumed that approximately 80% of a typical park's square footage consists of turf. The SVSP's parks will have a maximum cumulative total of all parks planned within this specific plan area turf area of 60%, with the remaining 20% area comprised of low water use plant species. Less than 60% is acceptable provided it is compatible with the amenities planned for the park.
- **Paseos and Landscape Corridors** – It is assumed that paseos and landscape corridors are typically comprised of 80% turf area. The SVSP's paseos and landscape corridors will have a maximum of 30% turf area, with the remaining 50% of the area comprised of low water use plant species.
- **Smart/Centrally Controlled Irrigation Controllers** – Smart and centrally controlled irrigation controllers restrict irrigation to only the times and water application rates that are necessary to maintain landscaping. They account for changes in the demand for water, which varies with weather patterns and seasonal influences. For the SVSP, smart irrigation controllers will be required for residential, small commercial, and quasi-public parcels subject to turf reduction measures, and centrally controlled irrigation controllers for larger commercial and publicly maintained parcels.
- **Recirculating Hot Water Systems** – This involves using a re-circulating pump on a home's hot water line system, reducing the time necessary to receive hot water at any hot water faucet. This type of system will be included on all residential units to generate additional plan-wide water conservation.

With full implementation of these measures throughout the Plan Area, it is estimated that the water conservation measures outlined above will reduce the SVSP's overall water demand by approximately 17% (or approximately 928 acre-feet) per year.

C. Water Transmission System

The SVSP will tie into the City's existing Pressure Zone 4 for potable water. Pressure Zone 4 includes the Del Webb – Sun City area, the North Roseville Specific Plan, the West Roseville Specific Plan, and areas west of the pressure reducing valves connecting Pressure Zones 1 and 4. Zone 4 has an approximate elevation range of 75-140 feet, and includes the SVSP. The City distribution system will supply water to the SVSP through connection points with Pressure Zone 4 at various locations needed to provide a reliable water network. These connections include an existing 24-inch main in Baseline Road, which currently terminates just east of the SVSP at the south end of the SVSP, the existing 16-inch main in Pleasant Grove Blvd., which currently terminates at the northeast boundary of the SVSP, and an existing 12-inch main in Fiddymont Road. Two additional future points of connection include a planned 24-inch main in Westbrook Blvd., which will terminate at the north boundary of the SVSP, and a planned 12-inch connection along Market Street. The planned water transmission system is shown on Figure 8-1.

The SVSP includes a 5.5 million gallon potable water storage tank with associated pumping and treatment facilities, and three groundwater wells. These facilities are planned on parcels FD-63, WB-61, and JM-60. The storage tank will serve the project site during high flow periods (i.e. peak hour) and emergency fire flow demand periods and will refill during periods of low demand. The three groundwater wells will provide the City with a backup water supply during dry years or during emergency conditions.

Water will be distributed within the SVSP via looping systems that parallel collector and arterial roadways on a transmission main grid. The transmission and distribution system consists of 6-inch to 24-inch diameter mains, as illustrated on Figure 8-1. All water improvements will be constructed to the City's standards using a phased approach.

Specific detail regarding the project water facilities are contained in the Sierra Vista Potable Water Master Plan on file with the City.

8.3 Recycled Water

The City will ultimately provide the SVSP with recycled water from the Pleasant Grove Wastewater Treatment Plant (PGWWTP). The SVSP will use recycled water to irrigate landscaping at parks, schools, commercial, business professional, and multi-family projects, as well as publicly landscaped areas (including roadway landscape corridors and medians). The estimated annual recycled water demand in the SVSP is 1,052 acre-feet per year (AFY), with a peak day demand of 1.56 million gallons per day (mgd). However, with implementation of the water conservation measures outlined in Section 8.2B above, the annual demand is reduced to 680 AFY. The use of recycled water for irrigation purposes offsets potable water demand and is an important component of the SVSP's overall water supply strategy.

The City is planning to supply recycled water to the SVSP by expanding the WRSP distribution system to include the SVSP. This would be accomplished by adding storage and pumping capacity and a supplemental groundwater supply well at the existing WRSP recycled water storage tank and pump station site, and connecting the WRSP to the SVSP at three locations. These locations are a 24-inch mainline planned in Westbrook Blvd., a 16-inch mainline in Market Street, and a 6-inch mainline in Pleasant Grove Blvd. During the initial phases of SVSP's development, the Plan Area, with approval from the City, may utilize potable water on an interim basis for irrigation. As the Plan Area develops and recycled water infrastructure comes online, the landscape areas that may utilize potable water will be transitioned to recycled water.

The planned distribution system within the SVSP will be a looped system, which will also include interties to the recycled water system within the WRSP. Pipelines in the SVSP, ranging in size from 6 to 24 inches, will be located primarily in planned roadways with pipes extending to parcels that need recycled water service. An additional 1.82 million gallons of storage will be added and the booster pump station will be expanded at the existing WRSP storage tank site. The planned recycled water backbone distribution system is illustrated on Figure 8-2.

All recycled water improvements will be constructed to the City's standards using a phased approach. Specific details regarding the project recycled water facilities and supplies, including technical analysis, are contained in the Sierra Vista Recycled Water Master Plan on file with the City.

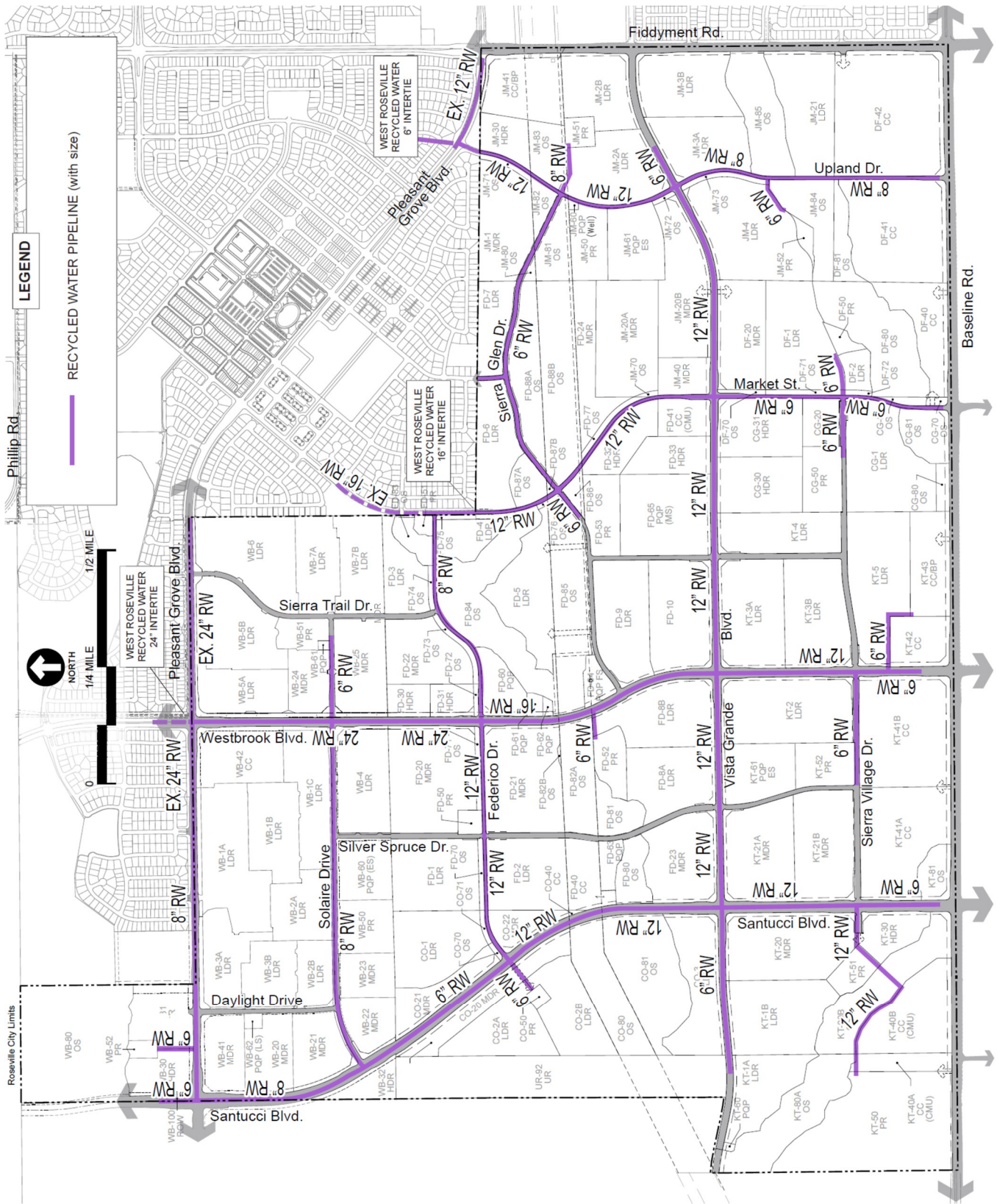

Figure 8-2: Recycled Water Distribution System

8.4 Wastewater

Sierra Vista's sanitary sewer service will be provided by the City of Roseville via the Pleasant Grove Wastewater Treatment Plant (PGWWTP). This facility is located north of the SVSP within the West Roseville Specific Plan area. The SVSP is estimated to generate an average dry weather flow of approximately 1.79 million gallons per day (mgd).

The backbone wastewater collection system is illustrated on Figure 8-3. Wastewater flows from the SVSP will be directed to PGWWTP by a network of pipes installed within street rights of way or easements. Sewer collection pipes will range in size from 6-inches to 21-inches. The sanitary sewer system will require two lift stations. The first lift station is located in the southwestern portion of the Plan Area on Parcel KT-60, south of Vista Grande Boulevard and west of Santucci Boulevard. The second lift station is located in the northwestern portion of the Plan Area on Parcel WB-62, to the southeast of the intersection of Santucci and Pleasant Grove Boulevards.

All sewer improvements will be consistent with the South Placer Regional Wastewater and Recycled Water Systems Evaluation and will be constructed to the City's standards using a phased approach.

Specific detail regarding the project sanitary sewer system are contained in the Sanitary Sewer Master Plan on file with the City.

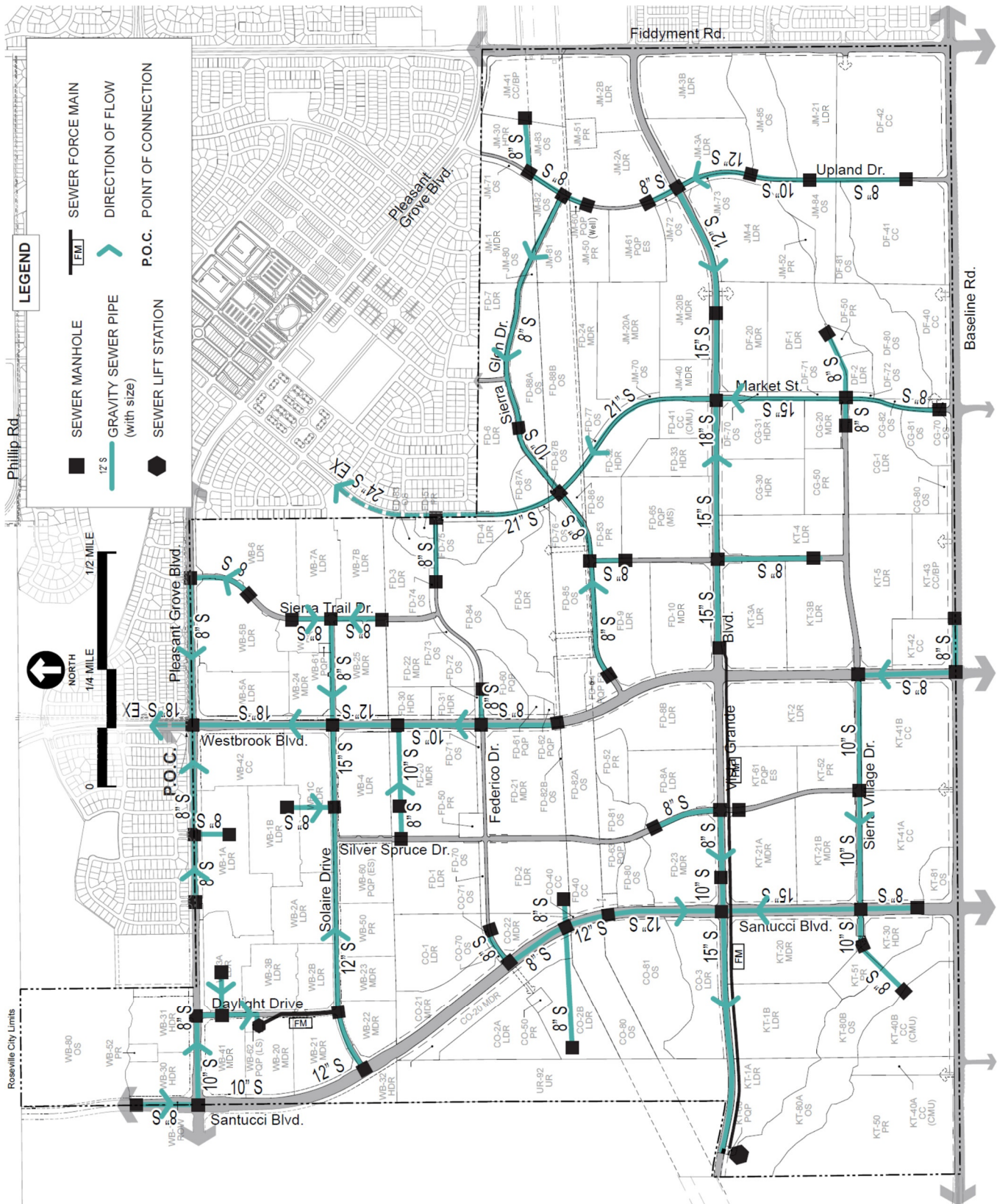

Figure 8-3: Wastewater Collection System

8.5 Drainage & Flood Control

The Sierra Vista Specific Plan (SVSP) is wholly contained within the Curry Creek watershed, which is located within the larger Natomas Cross Canal watershed of northwestern Placer County and southeastern Sutter County. The Curry Creek watershed drains to the Pleasant Grove Canal, to the Natomas Cross Canal, and then to the Sacramento River.

As described in Chapter 2, Context, Curry Creek traverses the southern portion of the Plan Area as a small seasonal stream, flowing from a pipe at Fiddymont Road, crossing to the south of Baseline Road, then reentering the Plan Area near Santucci Blvd., until exiting the western project boundary. The floodplain for Curry Creek varies in width from 500 feet at the east Plan Area boundary to 1200 feet at the west boundary. Federico Creek, a tributary of Curry Creek drains from east to west through the central portion of the SVSP and joins the main branch of Curry Creek just within the western boundary of the Plan Area. An additional tributary of Curry Creek is located near the northern boundary of the SVSP. This tributary conveys runoff from the WRSP to the future extension of Santucci Blvd. at the western boundary of the Plan Area. West of Santucci Blvd., flows are discharged into Placer County.

Hydrologic modeling indicates that on-site detention of runoff would contribute to a reduction of peak flows downstream. As a result, and to support full buildout of Sierra Vista, the plan will construct features within the floodplain which provide supplemental attenuation capacity for all peak storm water runoff within the open space and creek areas of the Plan Area. Adjacent to Curry Creek and its tributaries, additional flood storage will be excavated to enhance the attenuation characteristics of the over bank areas. The addition of bridges and culverts at roadway and trail crossings will be utilized to constrict the peak flows and increase the storage characteristics of the streams by metering downstream flows. Traditional permanent detention basins for peak stormwater flow attenuation are not planned.

The proposed project attenuation enhancement features will provide adequate mitigation to reduce peak runoff rates exiting the Plan Area without increasing the 100-year hydraulic grade line elevations at the Plan boundaries and offsite. Details relating to the sizing, timing, construction, funding, and maintenance of the attenuation features are included in the Specific Plan Development Agreements. The attenuation features will be included in the SVSP 404 Permit and will be incorporated into the Operations and Management Plan. Onsite drainage improvements and open space corridors are shown on Figure 8-4.

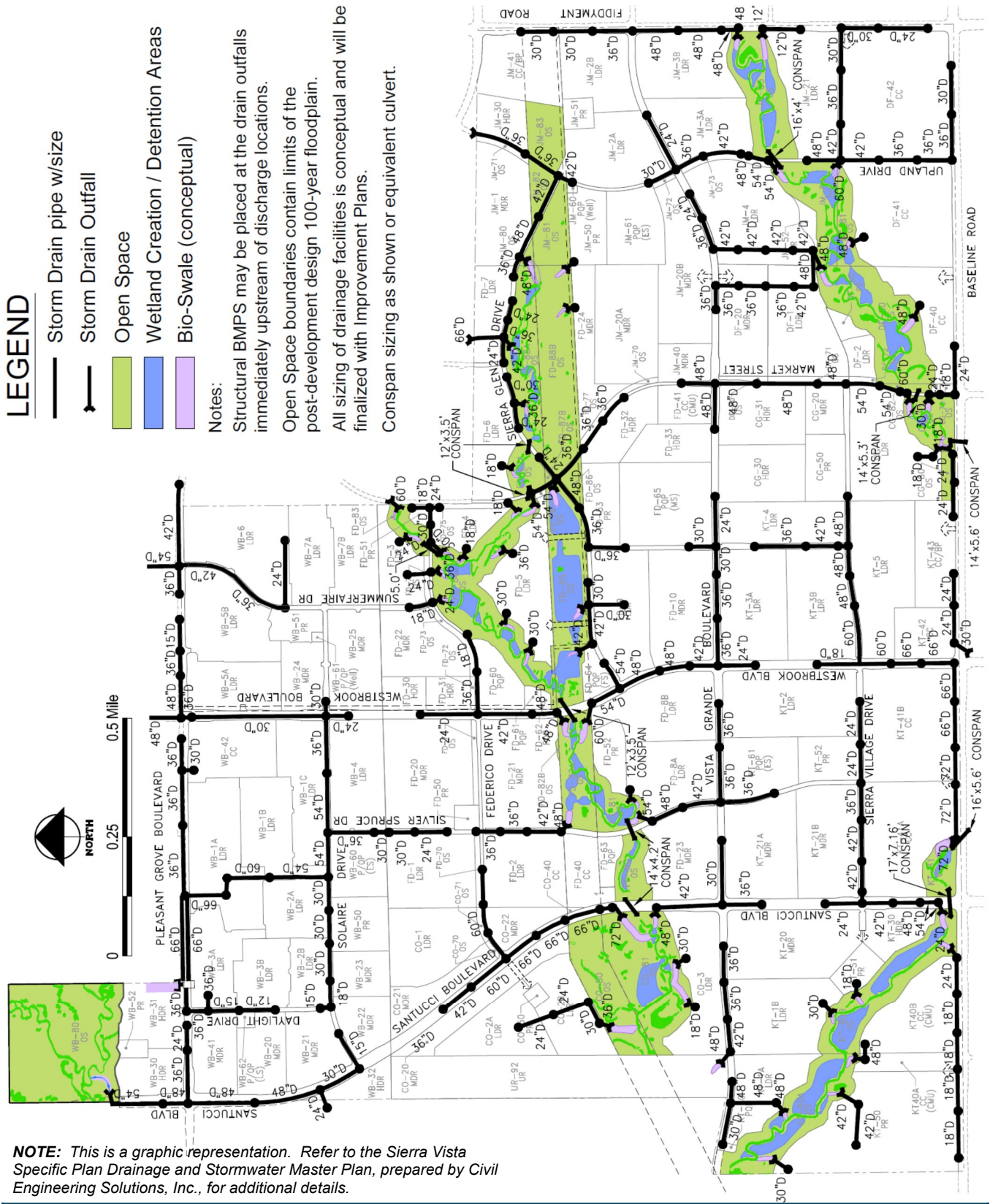

NOTE: This is a graphic representation. Refer to the Sierra Vista Specific Plan Drainage and Stormwater Master Plan, prepared by Civil Engineering Solutions, Inc., for additional details.

Figure 8-4: Drainage Improvements

In addition to detention of peak flood flows within the Curry Creek watershed, the SVSP will contribute towards construction of a regional retention basin via the City's drainage fee paid at time of Building Permit. This regional stormwater retention facility is located within the Pleasant Grove watershed and is planned at the City's Reason Farms site located to the northwest of the SVSP. The SVSP's contribution to the basin is approximately 238 acre-feet.

On-site drainage improvements consist of a combination of conventional subsurface and surface drainage systems, construction of pipe conveyance systems, and construction of culverts and bridges at roadway and trail crossings of creeks and tributaries. Stormwater will be discharged through outfalls into open space corridors. Vegetated swales, soft armoring, mechanical storm filters, structural interceptors and other best management practices will be utilized at pipe outfalls or other appropriate locations for water quality management, and to convey stormwater runoff to receiving waters while minimizing impacts to open space resources. Where applicable, outfall structures will be extended past any planned bikeways alignments in the open space areas.

The number and location of outfalls shown on Figure 8-4 is based on the best available information and is subject to refinement during the subdivision map and improvement plan approvals, as well as state/federal permitting. Drainage facilities will be designed and constructed in conformance with City of Roseville Improvement Standards, the City's Stormwater Quality Design Manual, the Placer County Flood Control Agency's Stormwater Management Manual, and an open space Preserve Operations and Maintenance (O&M) Plan, the preparation of which is a requirement of the Clean Water Act 404 permit. The Preserve O&M Plan will include requirements to minimize erosion and direct drainage away from vernal pool habitat by employing conceptual drainage improvements to be outlined in the plan (swales, outfalls, energy dissipation, and erosion control). The SVSP will append to the City of Roseville Preserve Area Overarching Management Plan, which was nearing completion at the time of Specific Plan approval. This "Overarching Plan" will replace all existing Preserve area O&M Plans and will be the new Citywide standard for Preserve area management, monitoring, and reporting.

Specific detail regarding the project drainage system is contained in the Drainage and Storm Water Master Plan on file with the City.

8.6 Stormwater Quality

Sierra Vista provides a comprehensive plan for the management of urban runoff for flow control and water quality improvement. The integrated stormwater management system plan is reflected, in part, in specific design criteria contained in this section. The objectives of the Sierra Vista stormwater management plan (SWMP) are intended to fulfill the requirements of the City's National Pollutant Discharge Elimination System (NPDES) Phase II Permit, as issued by the State Water Resources Control Board, and to minimize the effects of urban stormwater runoff on the natural open space areas, including wetland areas and principal drainage corridors.

The Sierra Vista SWMP will be in accordance with the then current permit criteria applicable at the time of development. The SWMP provides the frame work for stormwater treatment during two district components of the development process, first, during the construction phase while infrastructure is being built to support the community, and the post construction phase which will be part of the improvements that make up the community and continue to protect the natural resources in perpetuity.

A. Stormwater Management During Construction Activities

The release of on-site stormwater runoff during construction activities is regulated by the State General Construction Permit issued by the Regional Water Quality Control Board for all construction sites greater than one acre. The General Construction permit requires that a Storm Water Pollution Prevention Plan (SWPPP) is created to address how the storm water from a particular construction site will be maintained and treated prior to being discharged from the site. The SWPPP is an evolving document that changes with the dynamics of the site development.

The use of Best Management Practices (BMPs) during the construction process will generally incorporate erosion controls and sediment controls. Erosion and sediment control BMPs include such things as applying straw mulch to disturbed areas, the use of fiber rolls and silt fences, sedimentation basins, drain inlet protection, stabilized construction accesses, and material management. The final sizing and selection of non-mechanical BMPs will consider requirements specific to the Curry Creek watershed and proposed developed activities.

B. Post Construction Stormwater Management

Post construction stormwater management is intended to treat the urban runoff generated on-site in perpetuity. The BMP techniques within the Plan Area will reduce and/or eliminate the pollutants from the urban stormwater runoff and prevent the contamination of receiving waters. Sierra Vista will work with the then current permit criteria applicable at the time of development and in conformance with the City of Roseville Improvement Standards, the City's Stormwater Quality Design Manual, the Placer County Flood Control Agency's Stormwater Management Manual, the open space preserve Operations and Maintenance (O&M) Plan, to design and address post construction stormwater treatment.

Post construction stormwater treatment is composed of three general elements: source control, runoff reduction and treatment of runoff. All three elements will be used in the Sierra Vista SWMP. The basic practice of source control is to minimize the potential for constituents to enter runoff at the source. The main tool the project will employ towards the goal of runoff reduction, is the use of Low Impact Development(LID) measures. Implementation of LID includes the construction of decentralized small scale improvements that provide for local infiltration and treatment opportunities that reduce the quantity of runoff which enters the storm drain systems during a rainfall event. LID will be implemented to offset for runoff increases that occur with the development as a matter of the conversion of native ground surfaces to impervious cover. Additional Treatment control BMPs may be located at the end of the pipe and provide further treatment of the stormwater before it enters into the natural creek system.

Low Impact Development (LID)

Low impact development (LID) is an approach to stormwater management that emphasizes the use of small-scale, natural, constructed and proprietary drainage features integrated throughout the city to capture urban runoff and precipitation. LID measures can slow, clean, infiltrate and evapotranspire runoff, which reduce the quantity of urban runoff entering the city storm drain systems. The added opportunities for infiltration offered by the use of LID can add water to local aquifers, increasing water reuse. It is a sustainable practice that benefits water quality protection, stream stability and can contribute to water supply. The intent is to weave the textures of natural processes into the fabric of development. In addition to traditional storm water management, which collects and conveys storm water runoff through storm drains, pipes, or other conveyances to a centralized storm water facility, LID within Sierra Vista will take a different approach by using site design elements, LID and

storm water management to minimize changes to the site's pre-development runoff rates and volumes.

Key principles of low impact development include:

- ❑ Decentralize and manage urban runoff to integrate storm water management throughout the watershed.
- ❑ Preserve the ecosystem's natural hydrological functions and cycles.
- ❑ Account for a site's topographic features in its design.
- ❑ Reduce directly connected impervious surfaces to slow runoff and provide additional infiltration opportunities.
- ❑ Reduce impervious ground cover and maximize infiltration on-site.

As Sierra Vista develops, specific LID techniques, tools, and material will be used and specified in the construction documents that will control the amount of impervious surface, increase infiltration, and improve water quality by reducing runoff from the developed sites. The Sierra Vista master drainage study has accounted for the percent of runoff reduction expected with the implementation of these LID practices. Additional project design elements within the open space areas will also provide hydrograph modification benefits. The created wetland elements will provide additional floodplain storage capacity which is factored into the project hydrology analysis. The created wetlands also provide LID and treatment potential which has not been factored into the project mitigation, which include: added infiltration opportunities, evapotranspiration opportunities, nutrient uptake, biological filtering, and stream buffers."

A variety of LID elements may be implemented within Sierra Vista to achieve a reduction in stormwater runoff. The selection and use of these elements may vary by development project, depending on the runoff reduction needed. The various LID options may include, but are not limited to, the following:

- ❑ Disconnected roof drains;
- ❑ Disconnected and separated pavement;
- ❑ Bioretention facilities, rain gardens, and bioswales;
- ❑ Tree Planting;
- ❑ Grass swales and channels;
- ❑ Curb cuts and vegetated filter strips;
- ❑ Impervious surface reduction – permeable pavements and porous pavements;
- ❑ Stream Buffers;
- ❑ Soil Amendments; or
- ❑ Pollution prevention and good housekeeping practices.

End of Pipe Stormwater Treatment Control

In addition to the implementation of the above referenced LID measures, the storm drain system will be designed to provide additional protection of the natural environment and receiving water of Curry Creek by providing non-mechanical end of pipe treatment techniques. This element adds to the treatment train and consists of final treatment elements such as grass treatment swales.

Special consideration will be taken within Sierra Vista to capture, convey and release the urban storm water to the creek system. The treatment and conveyance of storm runoff in and through the open spaces will be made part of the Corp of Engineers 404 permitting process. Standard practices include the use of headwall structures, directly at the outfall location, that stabilize and protect the outlet pipe, surrounding topography and aid in velocity attenuation while minimizing future maintenance costs. Conveyance "grassy swales" that direct the storm water from the pipe outlet to the receiving waters, while avoiding sensitive habitat and distributing the concentrated pipe flows to a spread sheet flow will be used at every outfall in the project. Depending on the size of and frequency of particular storm events, and the actual drainage area being conveyed, the conveyance swales will be armored with geosynthetics that will minimize the potential for future erosion and rilling of the open space. This soft armoring approach will provide opportunity to create grassy swales and additional wetlands that will aide in storm water filtration and infiltration. Based on the level of LIDs proposed, additional "CDS" filtration units are not anticipated. However, additional structural BMP's can be added to the treatment train and end of pipe treatment if needed. These may include such devices as:

- Installation of "fossil filter" or equivalent petroleum absorbing insert assemblies in the project drop inlets;
- Trash screen vaults; or
- Other structural BMP's as approved by the City.

The final selection of BMPs will consider requirements specific to the Curry Creek watershed and proposed development flows. Other BMPs will involve prompt re-vegetation of disturbed areas and proper erosion protection per the NPDES permit during construction.

In one location, north of Pleasant Grove Blvd on the eastern side of Parcel WB-31, storm water will receive additional treatment prior to its discharge into the open space. At this location stormwater will be conveyed from the end of pipe(s) through a special design water quality treatment channel before being subsequently discharged into the open space. The details of this storm water treatment and conveyance channel are shown in Figure 8-5.

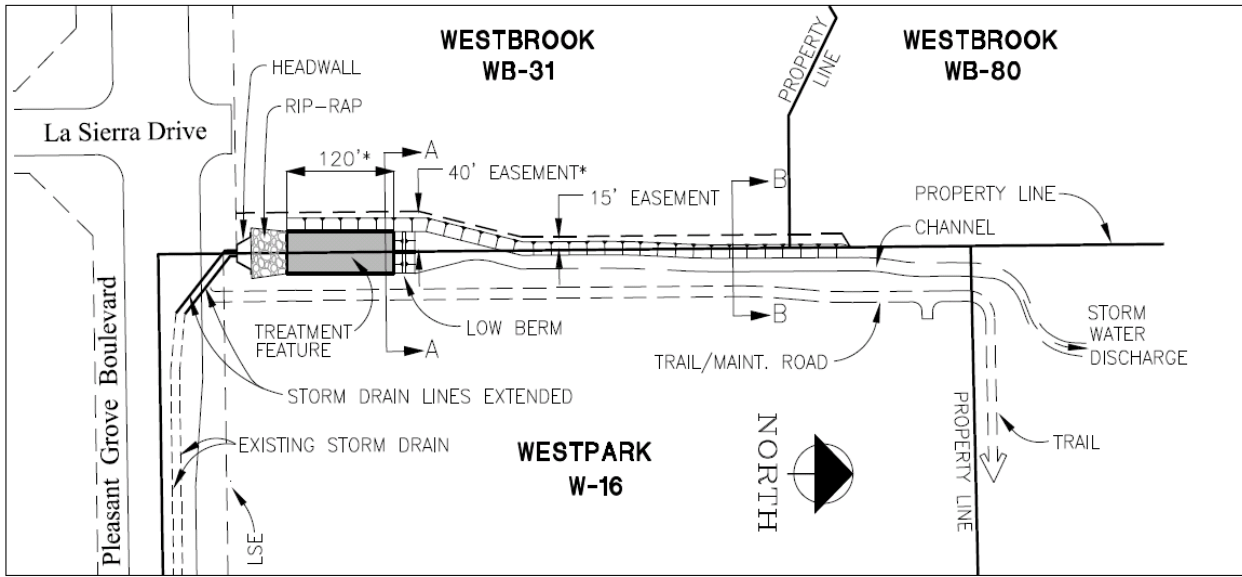

PLAN VIEW: WB-31 WATER QUALITY TREATMENT CHANNEL

* ACTUAL WIDTH TO BE DETERMINED WITH FINAL DESIGN

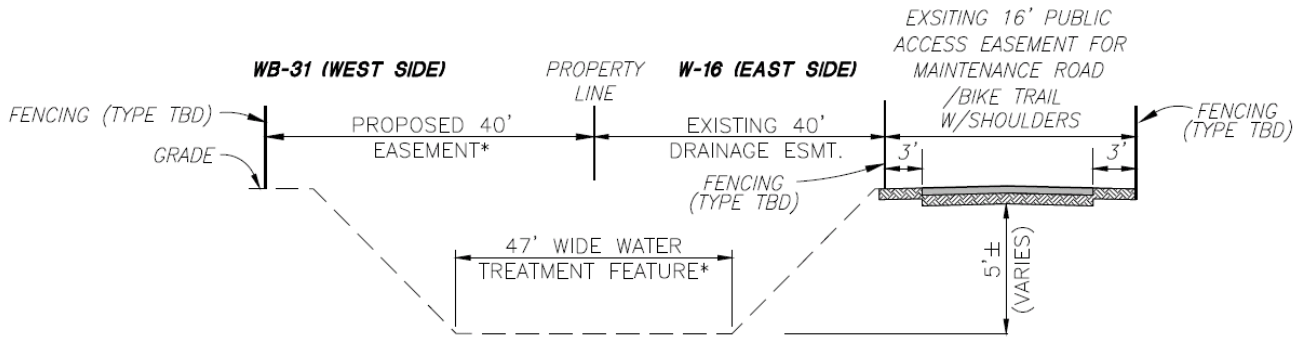

SECTION A-A

NTS

* ACTUAL WIDTH TO BE DETERMINED WITH FINAL DESIGN

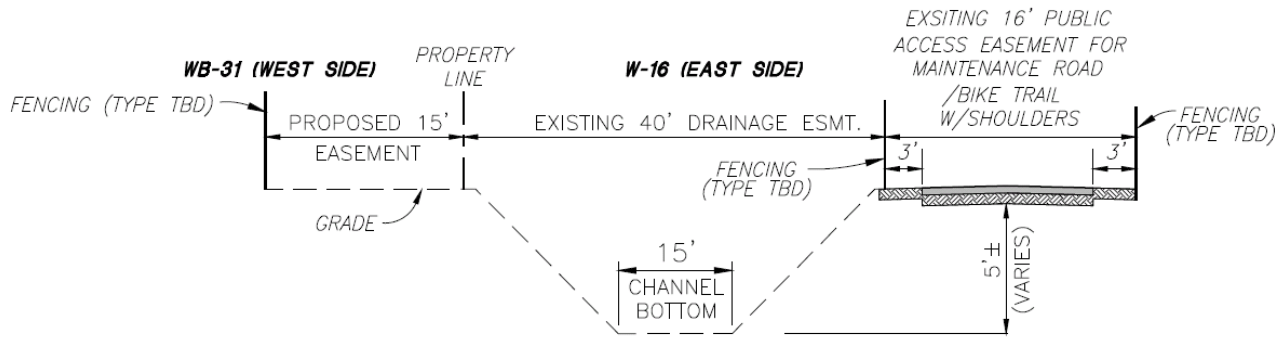

SECTION B-B

NTS

Figure 8-5: Stormwater Quality Treatment Channel for Parcel WB-31

8.7 Dry Utilities

A. Electric Service

Roseville Electric, the City's electric utility, will provide electric service to the SVSP.

Roseville Electric operates the Roseville Energy Park, a 160-megawatt natural gas fired electric power plant, which uses state-of-the-art equipment to locally generate more than half of the City's electricity needs. The Roseville Energy Park is located north of the Plan Area. Any additional electricity resources that are needed to serve SVSP, including state and federal mandated renewable electricity resources, will be purchased from outside sources or generated by new Roseville-owned generating facilities. As required by state regulations, Roseville will use energy efficiency programs and initiatives to meet electricity demand, before acquiring new electricity sources.

Peak electric demand for electrical service is estimated to be 70.5 million volt amps (MVA) (71.2 MVA including Urban Reserve parcel UR-92) within the SVSP. Planned electric backbone facilities include a substation and a 60kV transmission line corridor. The SVSP provides a 1.1-acre site (0.86 net acres on Parcel FD-61), centrally located in the Plan Area along Westbrook Blvd., for an electric substation. This substation will connect with Roseville Electric's existing 60kV overhead transmission lines that extend through the Plan Area, which completes a loop in west Roseville and provides connections to the Fiddymont substation and the substation in the WRSP. These transmission lines extend along the east side of planned Westbrook Blvd., between Pleasant Grove Boulevard and the substation site, and also along the south side of the WAPA corridor between Westbrook Blvd. and Fiddymont Road. An easement for the placement of a future dual circuit 60kV overhead line will be granted along the south side of Pleasant Grove Blvd. between Westbrook Blvd. and the western edge of the Specific Plan area. This line will only be constructed if there is a need for Roseville Electric to construct a substation site to feed new load requirements westerly of the SVSP. The location of the proposed electric substation and the alignments of the existing and future 60kV power line easements are shown on Figure 8-6.

Underground electrical distribution will be extended to individual parcels in conjunction with roadway improvements. In addition, street lighting will be provided along all public streets as part of the roadway frontage improvements. All electric and street light facilities will be constructed to the City's current standards at the time of construction.

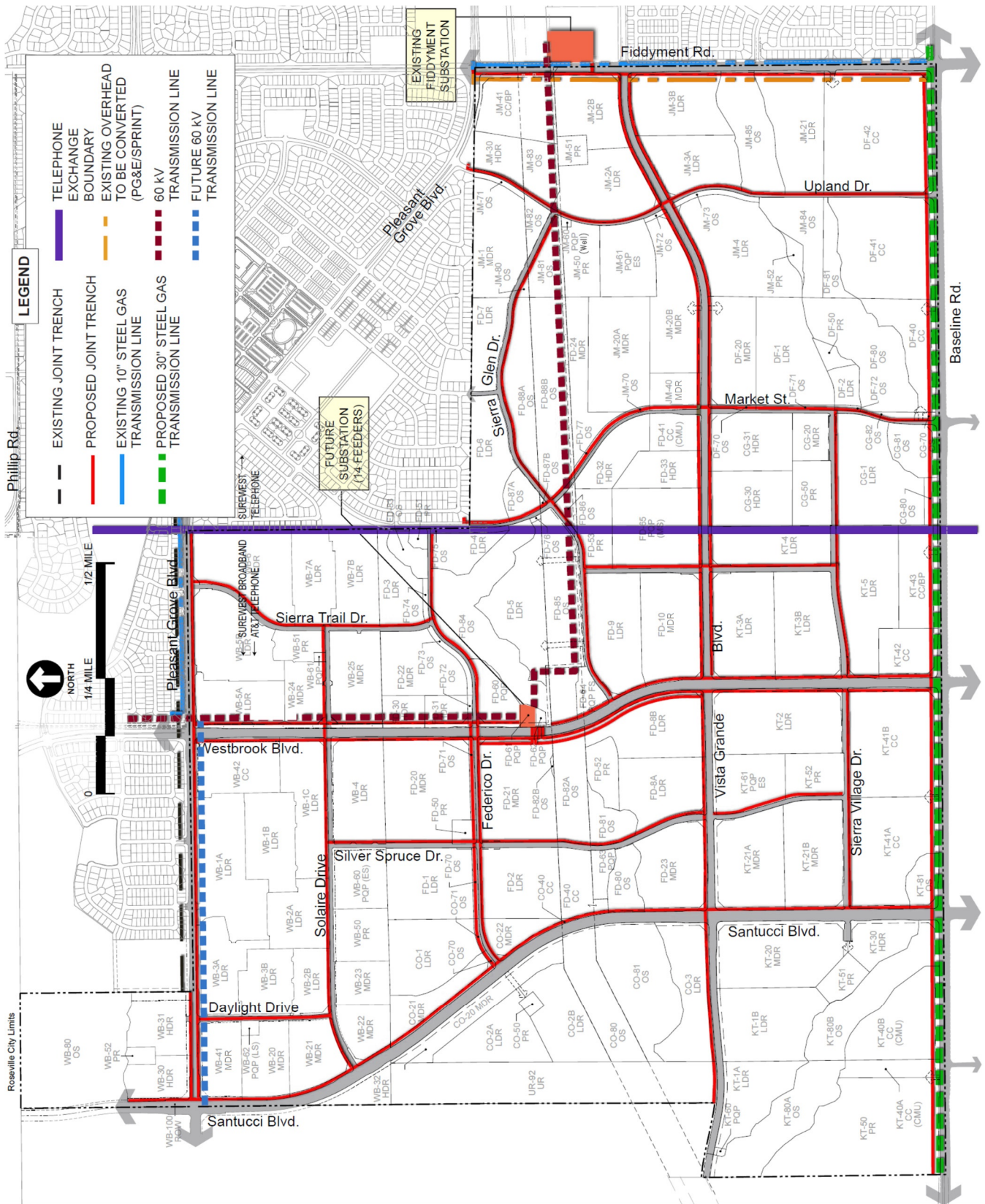

Figure 8-6: Electrical Substation and Power Line Alignments

B. Natural Gas

Pacific Gas & Electric Company (PG&E) will provide natural gas upon request and in accordance with the rules and tariffs of the California Public Utilities Commission. PG&E's long-range plans provide for availability of gas service to accommodate increased demand. Service will be provided to the SVSP from existing infrastructure adjacent to the Plan Area. Delivery of gas service to individual projects in the SVSP will be reviewed by PG&E at the time of proposal.

C. Communication

The SVSP is within the service areas of SureWest Communications, AT&T, Comcast, and Wave Broadband. Together, these providers offer both voice and data communication services to all development within the Plan Area. Distribution lines to individual parcels will be extended from existing infrastructure adjacent to the Plan Area in accordance with the infrastructure Phasing Plan for dry utilities. The appropriate providers will review delivery of telephone, cable television, and high speed data line services to individual projects in the SVSP at the time of proposal.

8.8 Solid Waste

The City of Roseville will provide solid waste services to the SVSP. Solid waste will be collected and delivered to the Western Placer Waste Management Authority facility located north of the City at Athens Avenue and Fiddyment Roads. The Authority owns a Material Recovery Facility (MRF) that receives, separates, processes, and markets recyclable materials removed from the waste stream. Residual waste is transferred to the Authority's Western Regional Sanitary Landfill located on the same site for disposal.

At full buildout, the SVSP is anticipated to generate approximately 48,358 tons of solid waste annually. Based on current city recycling efficiencies, it is expected that over half of the waste stream will be diverted from the landfill as recycled material. A 0.5-acre solid waste recycling area is planned within the SVSP on Parcel FD-62. This site will provide residents with a location to off-load recyclable materials. Vehicular access to this site is provided from Westbrook Blvd.